

| SIGN | DATE | DESCRIPTION                                    | APPROVER |
|------|------|--|----------|
|      |      | THIS IS CAD DRAWING, DO NOT REVISE MANUALLY!!! |          |

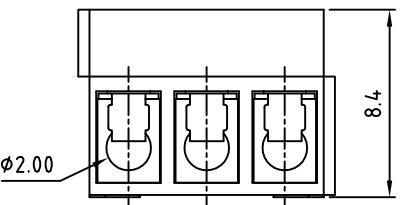

N=Number of contacts

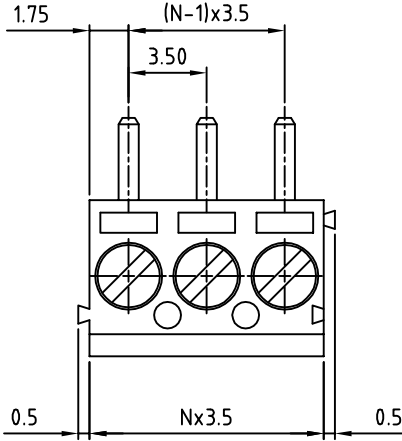
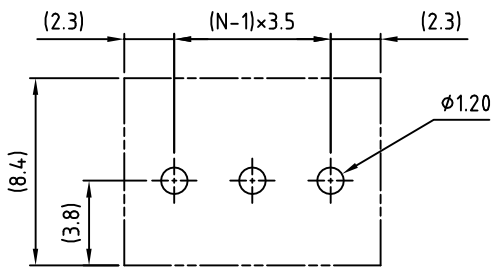
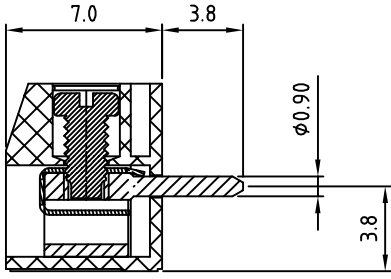

P.C.B. LAYOUT

**Material**

- Terminal body(metal housing): Brass(CuZn),Tin plated
- Terminal screw: Steel Zinc plating "-" slot type
- Wire guard :stainless steel
- Insulator (housing): Thermoplastic (UL94V-0)

**Electrical UL / CSA**

- Voltage rating: 125V/125V
- Current rating: 10A/10A
- Wire range:
  - Solid wire(AWG): 16-26 / 16-26
  - Stranded wire(AWG): 16-26 / 16-26
- Torque: 1.7Lb-In/4kgf.cm
- Screw: M2
- Wire strip length: 5-6mm
- Withstanding Voltage: 1.25KV/1.25KV
- Operating temperature: -30°C to +105°C
- Soldering temperature: 250°C±10°C/5 Sec
- Safety Approval:

RoHS Compliant

PART NUMBER:

**OSTTFXX0161**

- No. of Poles
- 02: 2 Poles
  - 03: 3 Poles
  - ...
  - 24: 24 Poles

- COLOR
- 0: Black
  - 5: Green
  - 6: Blue (Standard)
  - 8: Grey



THESE DRAWINGS AND SPECIFICATIONS ARE THE PROPERTY OF ON-SHORE TECHNOLOGY, INC. AND SHALL NOT BE REPRODUCED, COPIED OR USED IN ANY MANNER WITHOUT THE PRIOR WRITTEN CONSENT OF ON-SHORE TECHNOLOGY, INC.

| TITLE    |                      | OSTTF 3.5 series     |                      |  |
|----------|----------------------|----------------------|----------------------|--|
| PART NO. | OSTTFXX0161          | DWG NO.              | OSTTFXX0161.DWG      |  |
| APPROVED | CHECKED              | DESIGNED             | DRAWN                | CUST NO.   |
|          | Marvin<br>2007.02.02 | Marvin<br>2007.02.02 | Marvin<br>2007.02.02 |  |
|          |                      |                      |                      | Tolerance<br>X. ±0.50<br>X.X ±0.30<br>X.XX ±0.10<br>X° ±1° |
|          |                      |                      |                      | UNIT: mm<br>SCALE: NONE<br>REV.: B<br>SHEET: 01/01         |